

SINCE  
1965



# **WINDOORS** INTERNATIONAL LIMITED

ISO 9001,14001 & OHSAS-18001 Certified Company  
NSIC-CRISIL RATING - SE 1A



**Office**

**Accommodation**

**Kitchen**

**Tool Room**

**Toilet**

**Enclosure**

# From The Director's Desk

Since 1965

**WINDOORS** INTERNATIONAL LIMITED

ISO 9001,14001 & OHSAS-18001 Certified Company  
NSIC-CRISIL RATING - SE 1A

Why we are recognised as one of the best in the industry:

One of the Leading manufacturers of "PORTABLE CABINS".

The Most Experience

Over **46 Yrs.** of Professional experience.

The Best trained Technical Staff

Over **300** Employees.

Quality Policy.....Professional Association

The Industry **Price Leader**

Truly an Industry Leader

The **Highest Quality** Products,  
Produced over **10000** quality Units  
of different Shapes & Sizes.

Our Philosophy: **Better Products**.....**Competitive Price**

From the small office to complicated turnkey rooms we have built these units for just about every application & size for a number of projects.

Our design staff includes Structural, Mechanical, Electrical Engineers, Plumbing Technician & very highly trained Architectural Autocad operational staff.

We offer professional installations anywhere & guarantee your satisfaction.

Our Plants utilize modern, automated, production equipment materials that are inspected & tested through our on going quality assurance programme, assuring a consistent product of the highest quality. Our commitment ensures on-time instant installation anywhere in the country.

Our efficiency allows us to keep part of your project costs minimal with our innovative products.

We hope our product knowledge would provide us an opportunity to serve you in the future.

**We guarantee our products for 15 yrs. assurance..... that's how we define Quality !**



**WINDOORS** INTERNATIONAL LIMITED  
ISO 9001,14001 & OHSAS-18001 Certified Company  
NSIC-CRISIL RATING - SE 1A



# OFFICE

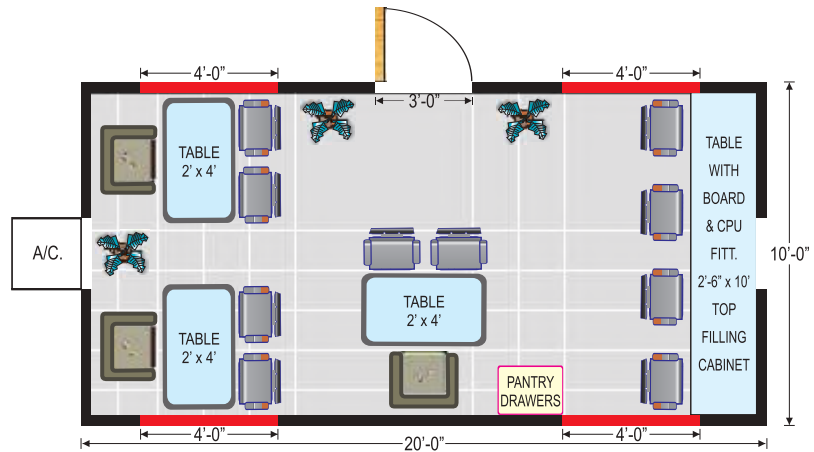

Concrete structures have given way to Portable Cabins & its today's need of the hour. In today's modern world everyone wants to work in a clean & green environment but only few actually come forward & try & to make a difference. Here's how we have put in sustained efforts for several years & have made people realise the importance of Portable Office & ways to preserve nature.

To provide customised solutions to end user. Faster occupancy, so you can get back to business. It's an asset to future projects & the most important advantages are in terms of monetary gains, time saving & recurring concrete structure expenses are eliminated.



Portable Cabins are sturdy and combine creativity with artistic beauty, optimum use of space with necessary accessories, furnitures & fixtures, Office cabins are made to suit various project requirements at site. These are tough externally & elegantly designed internally to make one feel lively & promote sense of professionalism.





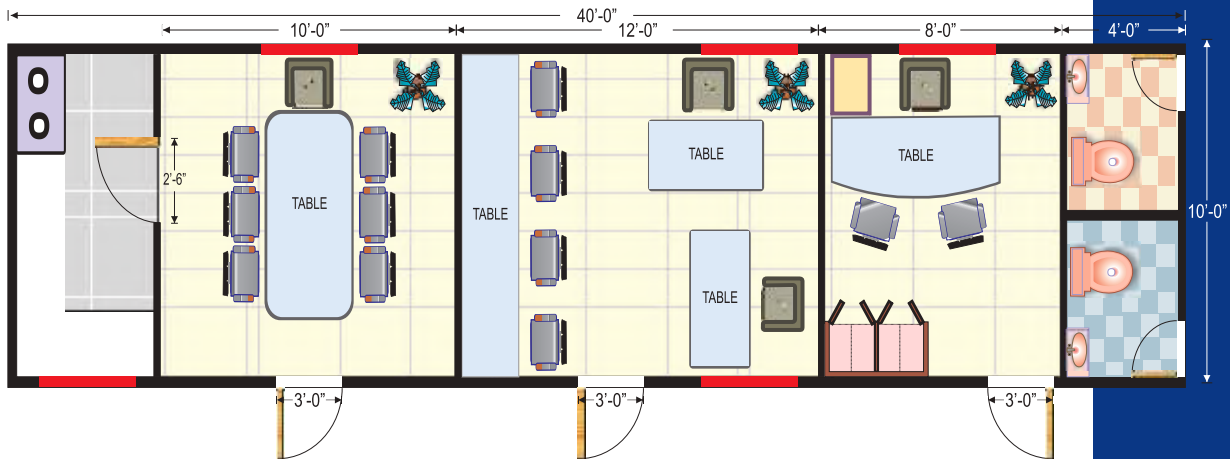

Portable Cabins are skillfully designed and are adaptable to suit variable climatic conditions. Branded materials of repute have been used. The main construction consists of specially formed Channels, Posts, Stiffeners & Corrugated Sheet. Insulation consists of 80mm/150mm Glasswool slabs which resists the heat. Internal decorative panelling, Metal false ceiling sections, Aluminium Powder coated Windows, Flooring can be provided with many options such as Vinly PVC Carpet, Wooden Flooring, Aluminium Chequered Sheets, Ceramic Tiles etc.



Cabins are fitted with concealed ISI approved Fire resistant wires & cables in PVC conduits. Tubes Lights, Door Lights, 5amps/15amps Switch Sockets for Air-Conditioners, Fans, Computers etc. are provided as per requirement. Main input at the exterior of the cabin are provided with Metal clad & MCB. Invertors, Generators can also be provided in case of power failure.

The Top of the Cabins consists of Tapered roof with specially corrugated sheet provided with drainage for easy flow of water on both ends & to avoid water logging. Tested Lifting hooks are provided for lifting & handling of the cabins for easy transportation & shifting.



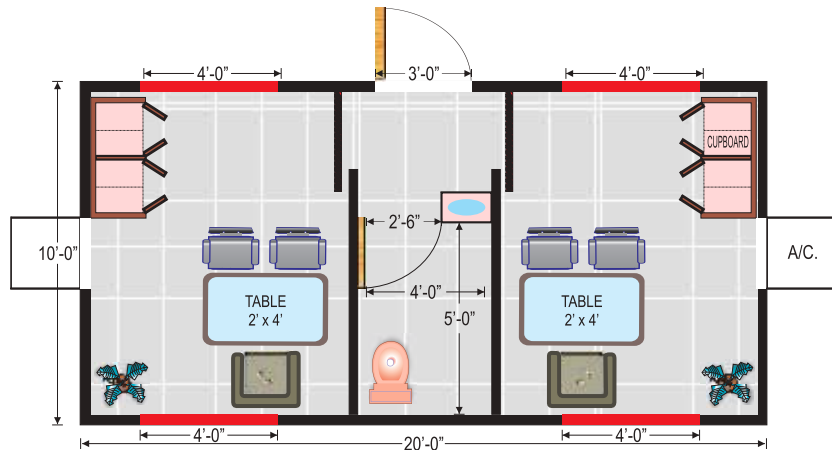

Portable cabins are manufactured under expert technical guidance using the latest machinery and stringent quality control & all these factors increase stability & durability of the cabins. The estimated life span of the cabins are approx - 15 years & therefore it works out to be the most beneficial, economical, speedy, dependable & convenient portable solution than other available conventional construction systems.

Portable office units can be classified into various sections like Bedroom with Toilet facilities, Halls, Canteens, Conference room, Dining Room, Sales /Marketing Office, Society Roof Top Office, Mezzanine Office, Testing laboratory, Ticketing Counters, and can also be used by professionals like Engineers, Doctors, Architects, Scientists etc.



Portable cabins are mainly used by Builders & Developers Turnkey Contractors, Road Contractors, Oil & Gas Industries for Drilling / Mining / Seismic, Military Base Camps, Logistics, Geological Departments , etc.





# ACCOMMODATION

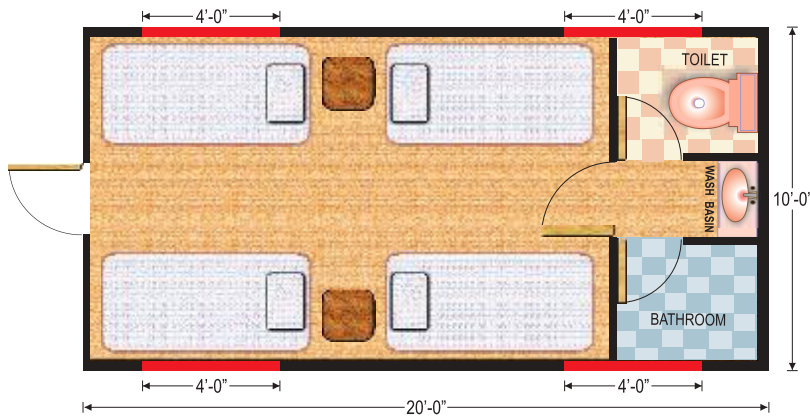

Our Accommodation units are spacious and uniquely designed with elegant interiors to make one feel cozy and enjoy blissful bedroom comforts. Accessories such as Single/Double Bunk/Folding type Beds with Mattress, covers, pillows, blankets etc. Cupboards, Lockers, Dressing Tables, Writing Table can be installed. The accessories can be provided & suited to the climatic conditions of the surrounding environment.



All electrical accessories are of standard make & lighting arrangements are designed to create a homely feeling. Hygiene toilets cum bathroom fitted with Shower, Water Mixers, Western/Indian Commode, Wash Basins, Geysers are also provided to the unit. Flooring can be of Vinyl carpet, Aluminium Flooring, Ceramic Tiles.

Our instant accommodation units are advantageous to various walks of life. These are mostly installed at locations not feasible to conventional structure & who are on the move. It's portability is the important factor which ultimately benefits the Organisation by saving on recurring concrete structure expenses.





# KITCHEN

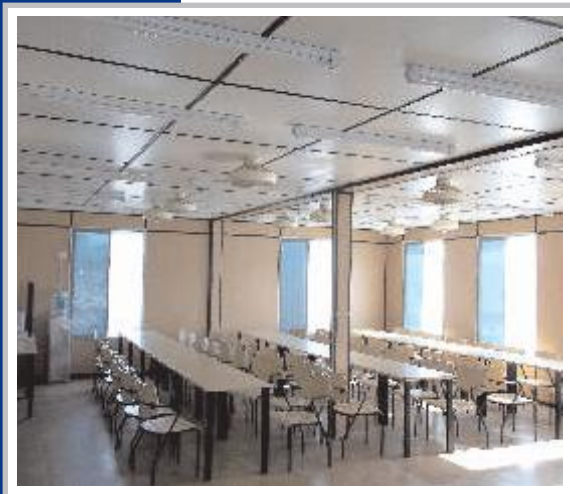
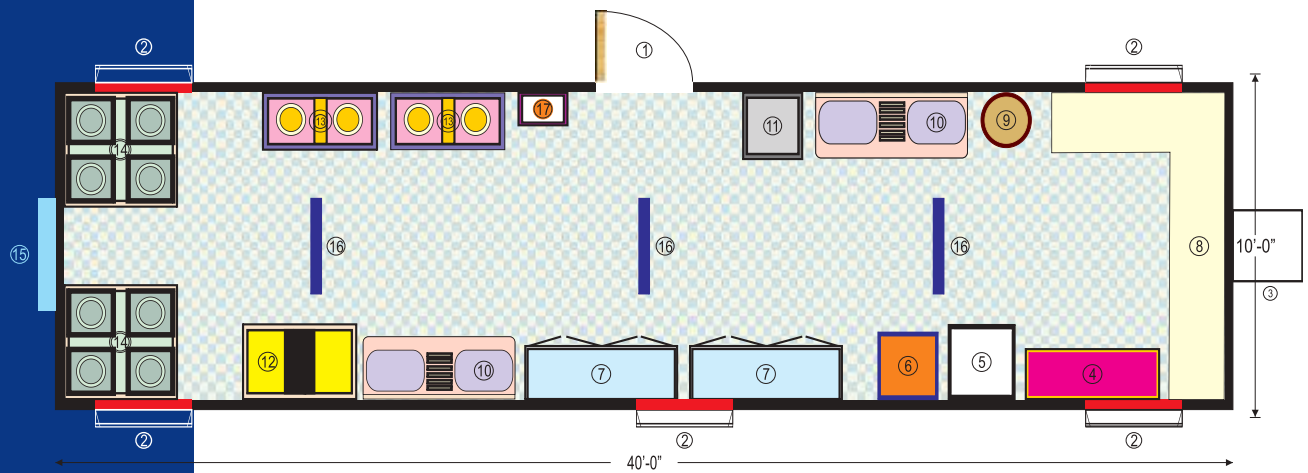

We make the best use of the kitchen & combine your personal taste with an aesthetic sense. We also offer very wide choice of innumerable combinations of storage & pull out units. We have implied necessary methods and have been successful in our efforts in creating a modular kitchen. Special arrangements have been made to reduce the temperature inside the units thus creating a workable atmosphere.

Fully equipped Kitchens consist of wide spread granite or marble table tops, Multi burners, cooking range Chimney, Microwave oven, Electric oven, Gas Cylinder Compartment, Storage Cupboards, Drawers, Wash Basins, Sinks, Overhead Water Tanks, Water Cooler, Fridge, Exhaust system, Fire fighting equipment, etc.



Our Kitchens are hygienic in nature & inculcate a working atmosphere. These are Heat, Water & Corrosion resistant and adapt to the changing atmospheric conditions. They can be lifted & transported from one place to another & are widely used by Oil Companies, Tour Operators, Catering Companies etc.





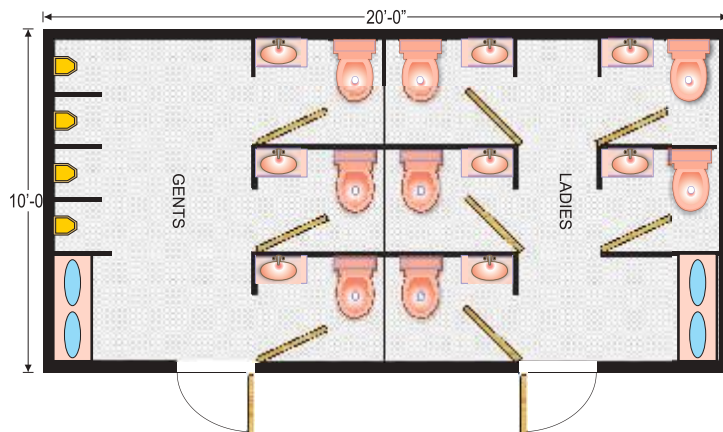

In today's world of hygiene culture, our portable toilet unit is an important necessity to the modern generation. The ideal solution for portable toilet facilities for leisure & hospitality events—whether permanent, temporary or in emergency cases. The toilet units are light weight and robustly designed for easy maintenance.



Our internal Toilet options include Commode Indian / European Style of Ceramic / Stainless Steel, Urinals, Wash Basins, Soap dispensers, Tissue holder, Towel holder, Fresh Water storage tank/ Holding Tanks, Hot & Cold water tap connection, Geyser, Water Pumps Sewage pumps, Flooring can be Aluminium chequered Flooring Ceramic Tiles etc.

Our hygienic toilet services every need from the provision of site welfare facilities to Construction Industry, For shut down units at Refineries, Outdoor Trade Fairs, Exhibitions, Sports Events, Weddings, Seminars, Garden Parties, Filming Location, Campsites, Camps etc.







Our Tool rooms are manufactured as per needs of the Organisations. It's mobility advantage can shift the toolroom to the required shut down areas. All necessary spares & accessories can be safely stored so they can be easily retrieved at the time of break downs & it's instant availability at plant area will save time & labour & help in quick normal functioning of the plant.

The toolrooms are provided with heavy doors & toughened glass windows for its safety & portability needs. Drawers, Racks, Storage units, Pullouts, Air Line, A/C - D/C Power supply . Shot blasted to prevent corrosion at sensitive locations. Heavy flooring is provided to withstand heavy Job handling required at the plant area..

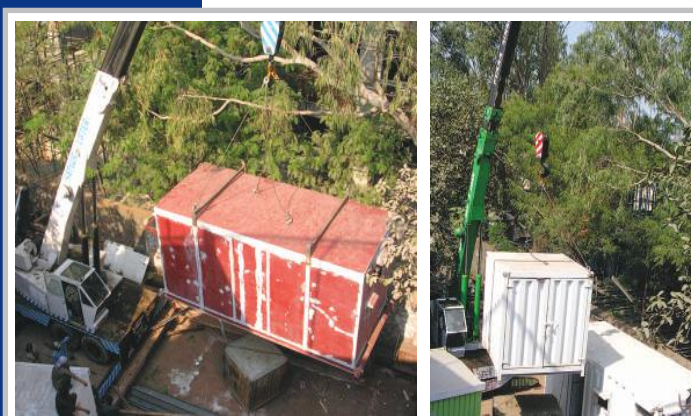

Our Portable Toolrooms can be installed at locations such as Drilling areas for Onshore Offshore Rigs, Refineries, Power Plant, Coal Mines, Fertilisers, Manufacturing plants, Thermal units, Windmills, Mobile Garages, Service centers, etc.



Environmental Rooms for high quality manufacturing meet the tough requirement of today's processes. These rooms control temperature, humidity & cleanliness at required levels. Wide clear span designs fit around equipment or processes without interference. To control temperature & humidity of the room and to isolate the manufacturing process from outside dirt contamination, thus ensuring the best possible manufacturing results.



Large door opening to allow for equipment removal. Glazed windows to allow monitoring the process. Wall and ceiling are removable panels sections made of smooth materials for easy cleaning. Standard electrical and lighting arrangement. Rooms have a positive pressure to prevent dust particles entering. Air Conditioning controls temperature and humidity.

An important requirement to Pharma Industries, Huge Traffic zones, Industrial manufacturing equipments, Mines explorer, Steel plants & for various sensitive locations.



# Recent Projects





***PORTABLE CABINS,  
BUNK HOUSES,  
PRE FAB BUILDINGS***



**WINDOORS** INTERNATIONAL LIMITED

ISO 9001,14001 & OHSAS-18001 Certified Company  
NSIC-CRISIL RATING - SE 1A

115, TEJPAL INDUSTRIAL ESTATE, KURLA - ANDHERI ROAD, SAKINAKA, MUMBAI - 400 072.

TEL.: 91-22-4257 8000 (100 lines), 2851 8413, 2851 0051, 2851 8352 FAX : 2859 3593

MOBILE: +91 98209 27229, 98192 58001, 98191 61618, 99690 28589

E-MAIL:

[dodias@windoors-india.com](mailto:dodias@windoors-india.com)

WEB:

[www.windoors-india.com](http://www.windoors-india.com)